

WACHOVIA TOWER

The Wachovia Tower

is a 34-story, Class AAA office tower located in the heart of Downtown Birmingham. The building has recently undergone a number of major renovations – providing a new Wachovia Banking Hall, state-of-the-art security and refurbished lobbies, restrooms, and mechanical systems.

Designed by Skidmore, Owings and Merrill (SOM) and Giattina Fisher Aycock, the Wachovia Tower was originally completed in 1986 and reaches an impressive 454 feet into the Birmingham skyline – making it the tallest building in the city.

The Wachovia Tower, a Birmingham landmark since 1986, now has available over 100,000 rsf for lease to corporate and professional users.



WACHOVIA TOWER

Prominently located at 420 20th St N in Birmingham, Alabama

511,039 rsf

Seven-level parking deck with room for 220 cars

17,419 rsf and 16,873 rsf floor plates

On-site banking

24-hour security

On-site management

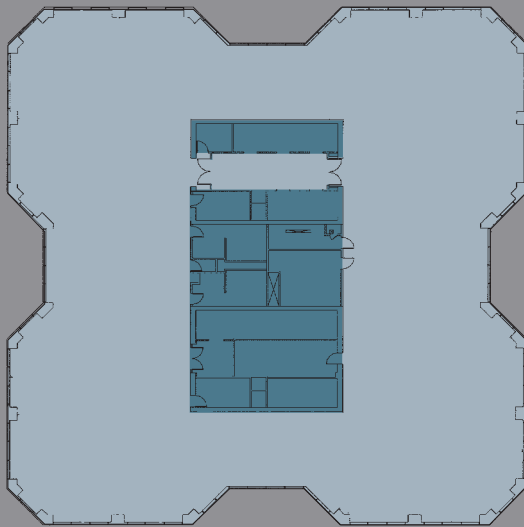

TYPICAL LOW-RISE FLOOR PLAN

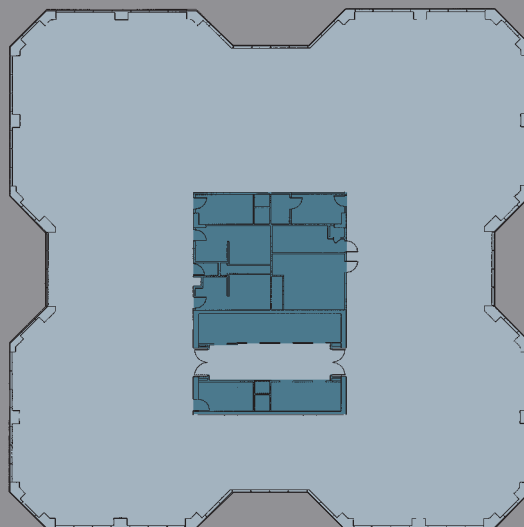

TYPICAL HIGH-RISE FLOOR PLAN

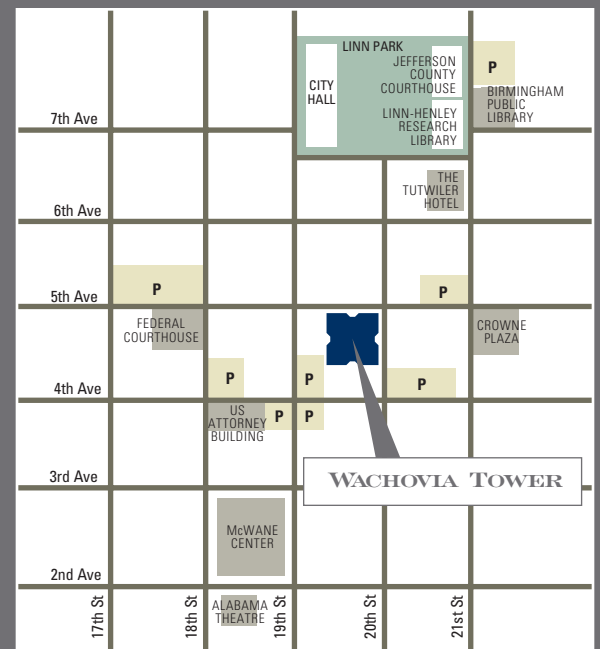
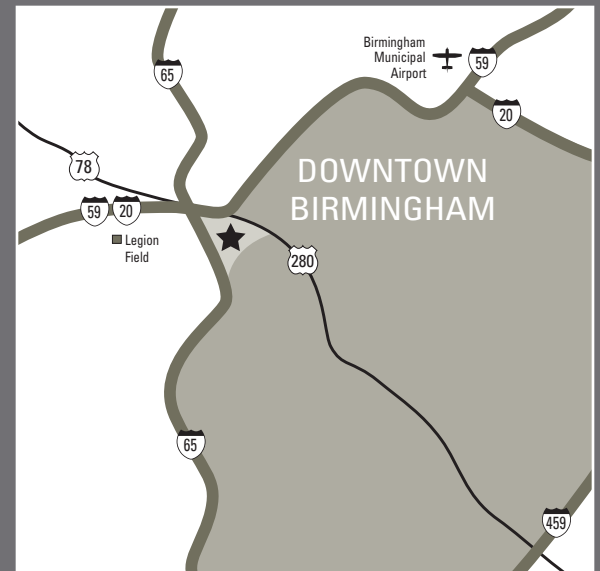

*for more information on
office space availability contact*

Joe Sandner, III SIOR
John Hennessy
Sandner Commercial Real Estate

office 205.445.0955

mobile 205.222.4440

